

High Quality Stainless Steel Turnbuckles/Rigging Screws

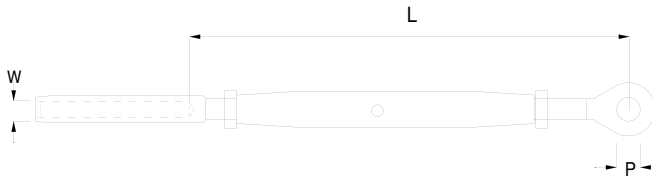

Marine Rigging Screws - Stud and Eye							
Product Code	Thread	W	P	T	MIN L	MAX L	WEIGHT
RSSE03	1/4" unf	3mm	6.3mm	6mm	115mm	185mm	62g
RSSE04DS	1/4" unf	3mm	6.3mm	6mm	117mm	187mm	63g
RSSE04	5/16" unf	4mm	8mm	7mm	140mm	215mm	106g
RSSE05DS	5/16" unf	4mm	8mm	7mm	142mm	217mm	108g
RSSE05	3/8" unf	5mm	9.5mm	8mm	170mm	270mm	194g
RSSE06DS	3/8" unf	5mm	9.5mm	8mm	173mm	273mm	197g
RSSE06	7/16" unf	6mm	11mm	9.5mm	190mm	295mm	298g
RSSE07DS	7/16" unf	6mm	11mm	9.5mm	194mm	299mm	302g
RSSE07	1/2" unf	7mm	12.7mm	11mm	225mm	355mm	466g
RSSE08DS	1/2" unf	8mm	12.7mm	11mm	225mm	350mm	500g
RSSE08	5/8" unf	8mm	14.3mm	14mm	285mm	410mm	968g
RSSE10	5/8" unf	10mm	16mm	15mm	290mm	445mm	1032g
RSSE12	3/4" unf	12mm	19mm	18mm	335mm	505mm	1626g
RSSE14	7/8" unf	14mm	22.2mm	22mm	375mm	570mm	2657g
RSSE16	1" unf	16mm	25.4mm	24mm	440mm	680mm	3694g
RSSE19	1 1/8" unf	19mm	28.6mm	28mm	495mm	765mm	3670g
RSSE22	1 1/4" unf	22mm	32mm	32mm	535mm	820mm	5442g
RSSE26	1 3/8" unf	26mm	35mm	34mm	615mm	940mm	11404g

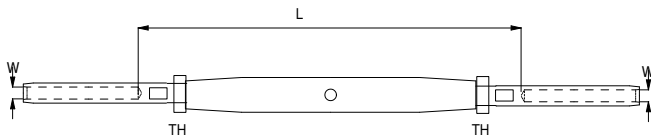

Marine Rigging Screws - Stud and Stud					
Product Code	Thread	W	MIN L	MAX L	WEIGHT
RSSS03	1/4" unf	3mm	115mm	180mm	70g
RSSS04DS	1/4" unf	3mm	117mm	182mm	72g
RSSS04	5/16" unf	4mm	135mm	215mm	112g
RSSS05DS	5/16" unf	4mm	137mm	217mm	114g
RSSS05	3/8" unf	5mm	165mm	265mm	200g
RSSS06DS	3/8" unf	5mm	168mm	268mm	203g
RSSS06	7/16" unf	6mm	180mm	290mm	330g
RSSS07DS	7/16" unf	6mm	183mm	293mm	334g
RSSS07	1/2" unf	7mm	215mm	345mm	504g
RSSS08DS	1/2" unf	8mm	220mm	350mm	572g
RSSS08	5/8" unf	8mm	275mm	430mm	1010g
RSSS10	5/8" unf	10mm	280mm	435mm	1102g
RSSS12	3/4" unf	12mm	325mm	495mm	1766g
RSSS14	7/8" unf	14mm	365mm	560mm	2795g
RSSS16	1" unf	16mm	425mm	665mm	3914g
RSSS19	1 1/8" unf	19mm	475mm	745mm	4230g
RSSS22	1 1/4" unf	22mm	515mm	800mm	6611g
RSSS26	1 3/8" unf	26mm	595mm	920mm	12649g

PRODUCT BENEFITS

Generously proportioned toggle straps are designed to take the full wire breaking load on each side of the eye and pin, avoiding premature failure due to transient unbalanced loads.

Stainless Steel 316 body with aluminium bronze inserts for sizes 8mm to 26mm.

All bodies have aluminium bronze threads ensuring **No Thread Seizing**.